



# LiteClik<sup>®</sup> 30 R / RX SafePlus<sup>™</sup>

## Infant Car Seat and Base Instruction Manual

4 - 30 lb (1.8 - 13.6 kg)

Up to 30 in (76.2 cm)

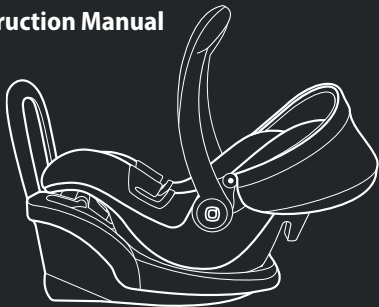

**READ INSTRUCTION MANUAL**  
before using this child restraint.

### WE LOVE TO HELP

**Hello there, welcome to the Diono® family!** We've created this lovingly engineered car seat to help keep your child comfortable and safe with all of the goods and none of the gimmicks.



**Any questions?**

**Diono U.S.: 1-855-463-4666**

**Diono Canada: 1-866-954-9786**

<b>Registration</b>	<b>7-8</b>
<b>Warning</b>	<b>9-15</b>
Expiration	
Certification	
Safe Practices	
<b>Use After a Collision</b>	<b>16-17</b>
<b>Infant Car Seat Parts</b>	<b>18-20</b>

# CONTENTS

<b>Base Parts</b>	<b>21</b>
<b>Initial Setup</b>	<b>22-25</b>
Anti-Rebound Bar	
Canopy	
<b>Vehicle Seating Locations</b>	<b>26</b>
<b>LATCH/UAS</b>	<b>27-31</b>
<b>Vehicle Seat Belt Types</b>	<b>32-38</b>
<b>80/20 Overhang Guidance</b>	<b>39</b>
<b>Handle</b>	<b>40-42</b>
<b>Base Installation</b>	<b>43-55</b>
Installation with LATCH/UAS	
Removal of LATCH/UAS Connectors	
Installation with Vehicle Seat Belt	
Securing and Removal Child Restraint to Base	
<b>Securing Child</b>	<b>56-69</b>
Buckle Strap Adjustment	
J-Routing Method	
Harness Strap Adjustment	

# CONTENTS

SitRite™ Comfort Insert

Securing Child

## **Infant Car Seat Installation**

**70-76**

## **Aircraft Installation**

**77**

## **Care & Maintenance**

**78-90**

LiteClik®30 RX Adapter\*

Buckle Strap Removal and Installation

Harness Strap Removal and Installation

Cover Removal and Installation

Canopy Shade\*

Cleaning

## **Warranty**

**91-94**

**\* ONLY INCLUDED WITH SELECT MODELS**

Diono® is proud to be Made of Seattle®, a city known for its pioneering spirit. We were born from a commitment to innovation and safety that began in 1999. Seattle's unique culture inspired us then, and continues to drive us today as we design revolutionary products that protect growing families and solve the challenges of a busy backseat.

Our passion for problem-solving has inspired us to create several groundbreaking industry firsts: Radian®, the original 3-across all-in-one convertible car seat; Monterey®, the original expandable booster seat; and now Connect3®, the first and only booster that fits 3-across.

Our dedication to world-class engineering and technical innovation means that whether you're on the road, out for a walk, or on-the-go with Diono, you can trust us to keep your family safe. We are honored that parents have been trusting us with their most precious cargo for over 25 years.

Today, over a million children travel safely in a Diono car seat every day. We're here to help you unlock the #JoyOfTheJourney, every step of the way.

Share your journey @Diono social or find the latest news on,



## REGISTER THIS CAR SEAT AND BASE

Please take a few moments to promptly fill out and return the attached card or register online using the direct link to the manufacturer's registration website provided.

Child restraints could be recalled for safety reasons. You must register this restraint to be reached in a recall. Send your name, address, e-mail address if available, and the restraint's model number and manufacturing date to:

**Diono® U.S.**, PO Box 77129, Seattle, WA 98177 or call 1-855-463-4666 or register online at: <http://www.Diono.com/product-registration/>

For recall information, call the U.S. Government's Vehicle Safety Hotline at 1-888-327-4236 (TTY: 1-800-424-9153), or go to <http://www.NHTSA.gov>.

## REGISTER THIS CAR SEAT AND BASE

**Diono® Canada ULC**, 2139 Wyecroft Rd, Oakville, ON L6L 5L7 or call 1-866-954-9786 or register online at: <http://www.Diono.ca/product-registration/>

For future reference, in the case of a change of address, please take a moment to fill out the following information:

**Model Number:**

**Manufacture Date:**

This information can be found either on the registration card or on the manufacturing label located on the seat.



U.S.



Canada



**⚠️ WARNING! DEATH OR SERIOUS INJURY CAN OCCUR! ⚠️**



**WARNING – Failure to follow these instructions and the product labels can result in serious injury or death to your child. Your child's safety depends on you. DEATH or SERIOUS INJURY can occur.**

- ▶ No child restraint can guarantee protection from injury in every situation, but proper use helps to reduce the risk of serious injury or death.
- ▶ Carefully read and understand all instructions and warnings in this manual. Your child's safety depends on you knowing how to set up, install and use this child restraint properly.
- ▶ This child restraint is designed for use only with children who weigh 4–30 lb (1.8–13.6 kg) and whose height is 30 in (76.2 cm) or less. The child restraint can be used with a vehicle safety belt or with the base.
- ▶ Before installing this child restraint in a vehicle, be sure to also check the vehicle owner's manual for information on proper installation.

**⚠️ WARNING! DEATH OR SERIOUS INJURY CAN OCCUR! ⚠️**

- ▶ Check all installation configurations before discarding the box. Diono® cannot guarantee proper fit in all vehicles.
- ▶ **According to accident statistics, children are safer when properly restrained in the rear seating positions than in the front seating positions.**



**NEVER PLACE THIS CHILD RESTRAINT REAR-FACING IN A VEHICLE SEATING LOCATION WITH AN ACTIVE FRONTAL AIR BAG. DEATH OR SERIOUS INJURY MAY OCCUR.** If an air bag inflates, it can hit the child or child restraint with enough force to cause serious injury or death to your child. For vehicles with side passenger air bags, refer to your vehicle owner's manual for information on your child restraint installation.

Take care to secure the child properly. Snugly adjust the harness straps provided with this child restraint around your child. A snug strap should not allow any slack. It lies in a relatively straight line without sagging. It does not press on the child's flesh or push the child's body into an unnatural position.

**⚠️ WARNING! DEATH OR SERIOUS INJURY CAN OCCUR! ⚠️**

## EXPIRATION

**DO NOT** use the child restraint if any part is damaged or broken, expired after eight years from date of purchase, missing instructions, missing parts, or if the straps are cut, frayed, or damaged in any way. For any questions or concerns or to find out if the damaged part(s) can be replaced, contact Diono® at:

**Diono® U.S.:** 1-855-463-4666 or online at [www.Diono.com](http://www.Diono.com)

**Diono® Canada:** 1-866-954-9786 or online at [www.Diono.ca](http://www.Diono.ca)

## CERTIFICATION



This child restraint system conforms to all applicable requirements of U.S. Federal Motor Vehicle Safety Standards (FMVSS) 213 and Canada Motor Vehicle Safety Standards (CMVSS) 213 & 213.1 and is certified for use in passenger cars, multi-purpose passenger vehicles, and trucks only.

**⚠️ WARNING! DEATH OR SERIOUS INJURY CAN OCCUR! ⚠️**



**This child restraint is certified for use in aircraft only when installed without the base.** The buckle of the aircraft seat belt interferes with the belt path of the base and cannot allow for proper installation. Diono® and the US Federal Aviation Administration (FAA) strongly urge you to secure your child in a child restraint system (CRS) or device for the duration of your flight. Please contact the airline for their specific policies.

## SAFE PRACTICES



- ▶ **FALL HAZARD:** Child's activity can move carrier. **NEVER** place carrier on counter tops, tables, or any other elevated surface.
- ▶ **The carrier can fall from the shopping cart. DO NOT use on shopping cart.**

- **DO NOT** modify your child restraint.

 **WARNING! DEATH OR SERIOUS INJURY CAN OCCUR!** 

- **NEVER** install it in a rear-facing or side-facing vehicle seat or on the back of a folded down vehicle seat.
- **DO NOT** leave loose objects, such as books, bags, etc., in the back of the vehicle. In the event of a sharp turn, sudden stop, or collision, loose objects can be thrown around and possibly cause serious injury to vehicle occupants.
- **ALWAYS** check all surfaces of the restraint before securing your child. In warm weather, child restraints can become very hot. Do not allow children to play with vehicle seat belts.
- **DO NOT** use the child restraint in any configuration not shown in the instructions.
- **ALWAYS** keep child properly secured in harness whenever child is in child restraint.

 **WARNING! DEATH OR SERIOUS INJURY CAN OCCUR!** 

- **ALWAYS** secure this child restraint , even when unoccupied, with the vehicle's child restraint anchorage system (LATCH/UAS) if available OR the vehicle seat belt. In a crash an unsecured child restraint system may injure other occupants.
- **NEVER** use the restraint system in a vehicle seating position where it cannot be secured tightly. A loosely installed restraint system will not protect your child in a collision.
- **DO NOT** use any accessories, inserts or products not included with this child restraint, unless approved by Diono®. Items not tested with this child restraint could injure your child.
- **DO NOT** use child restraint without seat cover installed.
- **ALWAYS** check seat belt or LATCH/UAS connectors to ensure all buckles are securely latched.

 **WARNING! DEATH OR SERIOUS INJURY CAN OCCUR!** 

- **NEVER** leave a child unattended. Do not allow children to play in or around the child restraint. Child may become tangled in harness straps and suffocate or strangle.
- **ALWAYS** secure harness snug and flat on your child.
- **NEVER** provide this child restraint to another person without also providing them with the instruction manual.
- **ALWAYS** install this child restraint in the rear vehicle seat whenever possible.
- **NEVER** place the child restraint with or without base in the forward-facing direction. It can be extremely dangerous for your child in the event of an accident.

## CAR SEAT USE AFTER A COLLISION

### UNITED STATES

The U.S. National Highway Traffic Safety Administration (NHTSA) recommends that car seats be replaced following a **MODERATE** or **SEVERE** collision in order to ensure a continued high level of collision protection for child passengers. In the U.S., child restraints do not automatically need to be replaced following a **MINOR** collision.

**NHTSA defines a MINOR crash as one in which ALL of the following apply:**

- The vehicle was able to be driven away from the crash site.
  - The vehicle door nearest the child restraint was not damaged.
  - None of the passengers in the vehicle sustained any injuries in the crash.
  - If the vehicle has airbags, the airbags did not deploy during the crash;
- and**
- There is no visible damage to the child restraint system.

**NEVER use a child restraint system that has been involved in a MODERATE or SEVERE collision.**



### CANADA

- **DO NOT USE THIS CHILD RESTRAINT SYSTEM IF IT HAS BEEN IN A VEHICLE ACCIDENT.**
- **Diono® designates that you MUST replace this child restraint system if it has been involved in a collision.**
- You must dispose of your child restraint or base if the child seat or base was in a vehicle during a crash. Even if the child seat or base was empty or was not directly hit, it may be damaged.
- You must dispose of your child restraint or base if the shell is cracked or the webbing of the child restraint is frayed, torn, or discolored.

## INFANT CAR SEAT PARTS

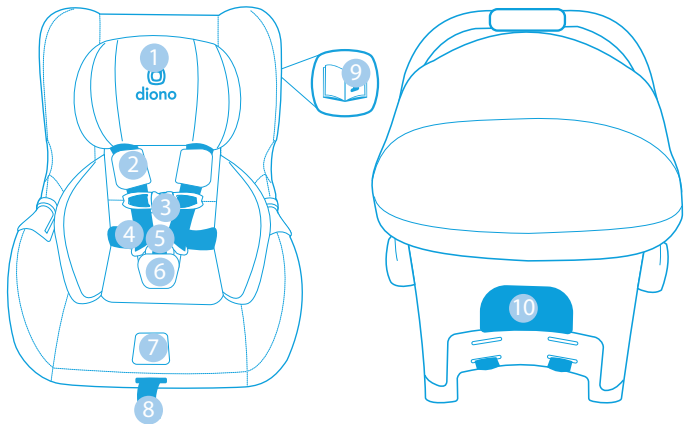

## INFANT CAR SEAT PARTS

1. SitRite™ Comfort Insert
2. Harness Pads
3. Chest Clip
4. Harness Straps
5. Buckle
6. Buckle Pad
7. Harness Strap Release Button
8. Harness Tightening Strap
9. Manual Storage Pocket
- Located under the cover**
10. Child Restraint and Stroller Release Lever

## INFANT CAR SEAT PARTS

11. Canopy
12. Handle Adjustment Button
13. Handle
14. Level Line Indicator
15. Vehicle Seat Belt Guide

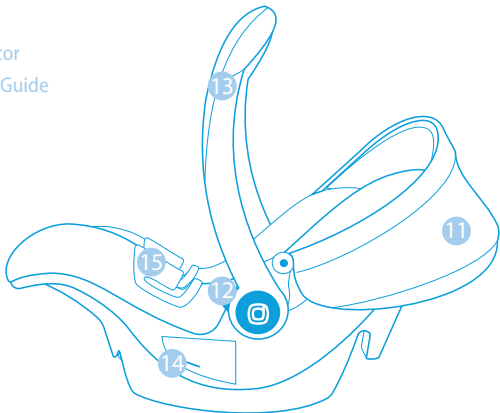

## BASE PARTS

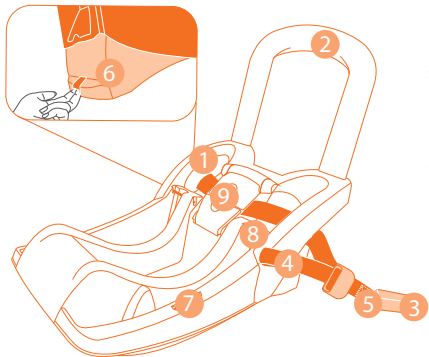

1. Base Belt Guide
2. Anti-Rebound Bar
3. LATCH/UAS Connector
4. LATCH/UAS Strap
5. LATCH/UAS Red Release Button
6. Five-Position Leveling Foot
7. Bubble Level Indicator
8. Carrier Attachment Hooks
9. EasyPath™ Belt Lock-Off and LATCH/UAS Storage Compartment

### ANTI-REBOUND BAR

#### ATTACH

1. Insert the anti-rebound bar into the slots located on the base with the SafePlus™ Engineering logo facing away from the base.
2. Push down firmly on the anti-rebound bar to securely attach it to the base.
3. Pull up on the anti-rebound bar to make sure it is securely locked into place. If the anti-rebound bar is not locking into place, ensure you are inserting it with the SafePlus™ Engineering logo facing away from the base.

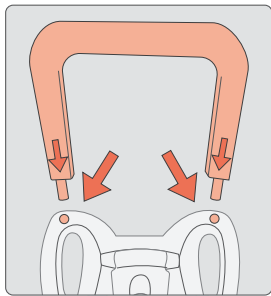

### DETACH

To detach the anti-rebound bar, push in the metal pins located on the anti-rebound bar pegs with a blunt object while you pull up on the anti-rebound bar.

***Note: you may need two people to remove the anti-rebound bar.***

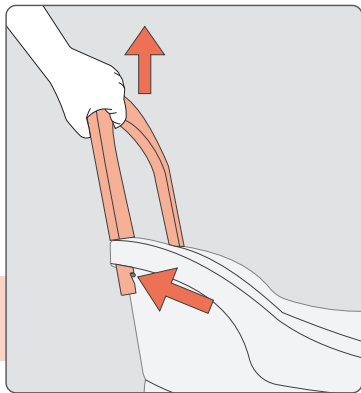

### CANOPY

- ▶ **Make sure the canopy frame is securely attached before securing the child in the child restraint.**

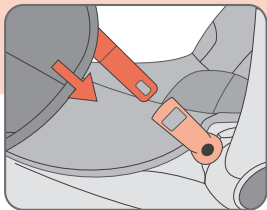

### ATTACH

1. Insert both sides of the canopy frame into the canopy hinge bracket so that the hook and loop strips are located at the back of the child restraint.
2. Fasten the hook and loop strips located along the back of the child restraint cover.



### DETACH

1. Detach the canopy from the hook and loop strips located on the back of the child restraint cover.
2. Pull each side of the canopy frame out of the canopy hinge brackets.

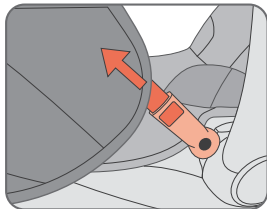

- ▶ **Remove the canopy from the canopy frame before washing.**

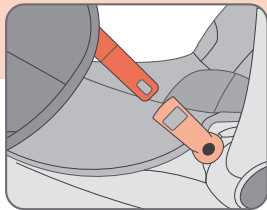

## VEHICLE SEATING LOCATIONS

**PLEASE READ YOUR VEHICLE MANUAL THOROUGHLY AND ONLY INSTALL YOUR CHILD RESTRAINT IN THE CORRECT SEATING LOCATIONS.**

**NEVER** place this child restraint rear-facing in a vehicle seating location with an active frontal air bag. If the airbag inflates, it can cause serious injury or death to your child. For vehicles with side air bags, refer to your vehicle owner's manual for information on your child restraint installation.

The American Academy of Pediatrics (AAP), NHTSA, Transport Canada and Diono® **RECOMMEND** that children be rear-facing until they reach the maximum rear-facing height or weight of their car seat. This child restraint is designed for use only with children who weigh 4–30 lb (1.8–13.6 kg) and whose height is 30 in (76.2 cm) or less.



**Rear-facing is the safest position for your child.** Even if your provincial, territorial, or state regulations allow you to move to a forward-facing seat, your child should keep using a rear-facing seat as long as possible.

### WHAT IS LATCH/UAS?

Most vehicles manufactured after September 1, 2002, are equipped with:



**U.S.: LATCH** (Lower Anchors and Tethers for CHildren)

**Canada: UAS** (Universal Anchorage System)

Check your vehicle owner's manual to determine LATCH/UAS compatible seating positions. Some vehicle manuals use the term "ISOFIX" instead; LATCH/UAS can also be used in vehicle seating positions that are equipped with ISOFIX. Look for the LATCH/UAS symbol that may be visible by the seat bight of the rear seats. **DO NOT install using both LATCH/UAS connectors and the vehicle seat belt at the same time.**

### VEHICLE LATCH/UAS ANCHORS

The safest seating position is one that works best for your specific child restraint, family, and vehicle model.

Before installing this child restraint, you must determine the method of installation and the best vehicle seating position for that method. According to accident statistics, children are safer when properly restrained in the vehicle's rear seating positions than in the front seating positions.

**This child restraint can be installed either using LATCH/UAS or the vehicle seat belt.**

- ▶ **DO NOT install using both methods at the same time.**

## LATCH / UAS

When determining whether the child restraint can be used with vehicle LATCH/UAS anchors in the rear center seating position, it is critical that you refer to your vehicle owner's manual. If the child restraint does not install best in the rear, center seating location, it is recommended to move to one of the outboard seating positions.

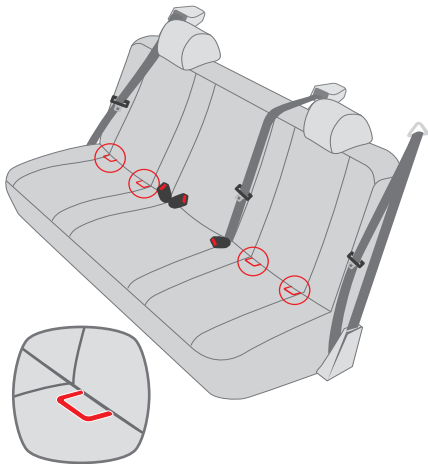

### ATTACH

**When attaching the** LATCH/UAS connector to the vehicle LATCH/UAS anchors,

- Make sure there is only **ONE** connector per vehicle anchor.
- Each LATCH/UAS connector strap is lying flat and not twisted.
- You will hear an audible **“click”** to confirm engagement.

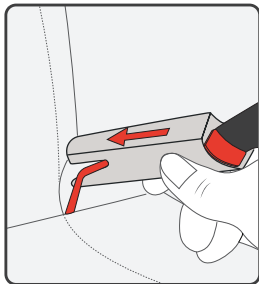

### REMOVE

- **Loosen** the LATCH/UAS system by pushing the grey button and pulling down from the main LATCH/UAS strap
- **Remove the** LATCH/UAS connectors from vehicle anchors by **pushing the red release button** on the connectors.

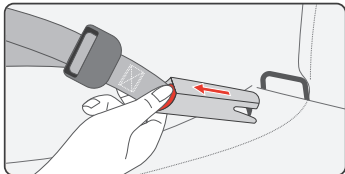
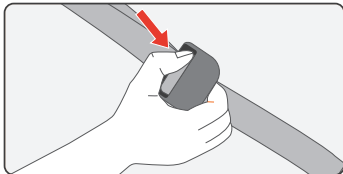

- ▶ **Store the connectors in the LATCH/UAS storage area on the top of the base.**

## VEHICLE SEAT BELT TYPES

The following types of vehicle belts **CANNOT BE USED** with your child restraint.

If any of the belt types listed below are in the chosen seating position, you **MUST** choose another seating position or use LATCH/UAS if available.

1. Motorized (Automatic) Vehicle Belts
2. Dual Retractor Lap/Shoulder Belts
3. Non-Locking (ELR) Lap Belts
4. Inflatable Seat Belts
5. Door Mounted Vehicle Belts

***Please refer to your vehicle owner's manual for specific information about seat belts and their use with child restraints.***



## VEHICLE SEAT BELT TYPES

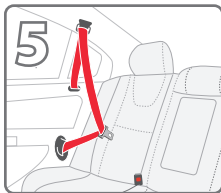
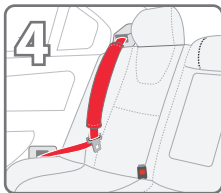
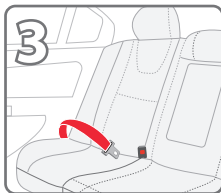
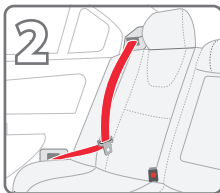
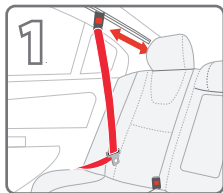

### TYPES OF SEAT BELT LATCH PLATES SAFE TO USE WHILE SECURING YOUR CAR SEAT



**1. Lap Belt with Locking Latch Plate.**

- Once buckled, the vehicle belt is tightened by pulling on the free end of the strap until the belt is tight.

**TIP:** A way to tell if the lap belt has a locking latch plate is to sit in the vehicle and buckle yourself in. Pull gently on the lap belt. If it stays tight, it is locked.



**2. Lap Belt with Automatic Locking Retractor (ALR).** The automatic locking retractor does not allow the lap belt to get longer once it is buckled and retractor is locked.

- The vehicle belt is tightened by feeding seat belt webbing into retractor after it has been locked.

## VEHICLE SEAT BELT TYPES



3. **Lap/Shoulder Belt with Locking Latch Plate.** The lap portion of this belt does not loosen once the belt is buckled.

- The vehicle belt is tightened by pulling up hard on shoulder belt and feeding the extra webbing into the retractor.



4. **Lap/Shoulder Belt with Sliding Latch Plate with Locking Retractor.** The latch plate slides freely along the lap/shoulder belt.

- Vehicle belts with sliding latch plates are typically locked at the shoulder belt retractor by pulling all of the webbing out slowly until it stops to switch the retractor.

## VEHICLE SEAT BELT TYPES

**DO NOT use Non-Locking Latch Plates** to secure your car seat. Types of non-locking latch plates are:

- Sliding Latch Plate with an Emergency Locking Retractor.
- Dynamic Latch Plate
- Sewn-On Latch Plate

**NOTE:** *LATCH/UAS can be used **IN PLACE** of these vehicle belt types. Please refer to your vehicle owner's manual for further information on which type of **LATCH PLATES** are located in your vehicle.*

## TYPES OF RETRACTORS

### 1. **Emergency Locking Retractor (ELR)**

- Only locks with sudden stops, accelerations, turns or if involved in an accident.
- You **MUST** use LATCH/UAS or a locking clip if your vehicle is only equipped with ELR retractors.

## VEHICLE SEAT BELT TYPES

### 2. **Automatic Locking Retractor (ALR)**

- Found in older vehicle and can be used to install this child restraint system.

### 3. **Switchable Retractor** Most common type of retractor and is switchable from (ELR) to (ALR).

- **MUST** switch to **(ALR)** mode when installing this child restraint without the base.

### 4. **No Retractor**

Some older vehicles do not have a retractor to store the excess seat belt webbing, leaving the excess webbing visible. **Lap belts without a retractor will always have a latch plate that provides the locking feature necessary to secure your car seat properly.** *Review your vehicle owner's manual for specific instructions on what type of seat belt system your vehicle is equipped with.*

### SWITCHING YOUR RETRACTOR FROM (ELR) TO (ALR) MODE

1. Feed the latch plate/seat belt into the belt path. Be sure the belt is flat and not twisted.
2. Click the latch plate into the vehicle's seat belt buckle.
3. Locate the retractor then gently pull the seat belt out of the retractor until it stops, then slowly feed webbing back into retractor.

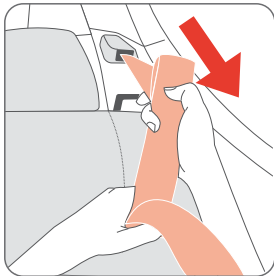

- ▶ **You will hear clicking. This is how you know you have switched the retractor to ALR mode.**

## 80/20 OVERHANG GUIDANCE

To follow 80/20 overhang guidance, ensure that no more than 20% of the car seat base overhangs beyond the front edge of the vehicle seat cushion.

### ESTIMATING METHOD

1. Estimate the halfway point of the car seat base.
2. Then halve the outer half (the half farthest from the seat bight) to mark the spot that would be about 75%.
3. Add a bit more to the footprint that is supported by the seat cushion. This will be around 80% and that would be meeting the 80/20 overhang guidance.

- ▶ **If results are unclear using the estimating method, use a tape measure and do the math.**
- ▶ **This method does not apply for installations when not using the base.**

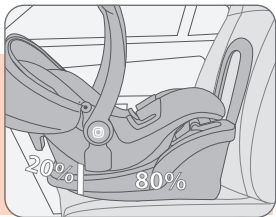

## HANDLE

### HANDLE POSITIONS

- ▶ **DO NOT** place the child restraint on an elevated surface

The handle has four positions.

1. Stationary Position
    - Stabilizes the child restraint.
  2. Resting Position
  3. Carry Position
  4. Anti-Rebound Position
- ▶ Handle must be in position 4 when your child restraint is installed in your vehicle without the base.



## HANDLE

### IMPORTANT!

- ▶ When the carrier is installed with the base you may use handle position 2 or 3. **DO NOT use position 1 or 4.**
- ▶ When the carrier is installed without the base you must use handle position 4 only. **DO NOT use any other handle positions.**

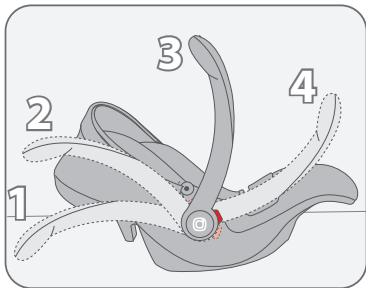

## HANDLE

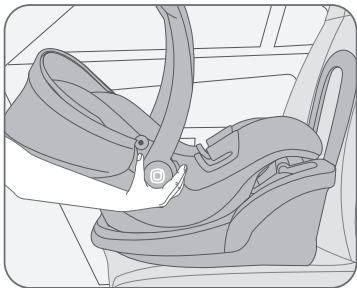

### ADJUSTING HANDLE

When using the child restraint with a child, it is important to always ensure that the handle is securely locked in one of the designated positions.

**To adjust the Handle, press both of the Handle Release Buttons and rotate the handle.**

## BASE INSTALLATION

- ▶ **Only use this base with the LiteClik®30 R and RX SafePlus™ Infant Car Seats.**
- ▶ **Before installing a child restraint base, make sure your vehicle is on level ground.**

1. Place the child restraint base on selected vehicle seat. Make sure it does not block the vehicle seat belt buckle or LATCH/UAS anchors.

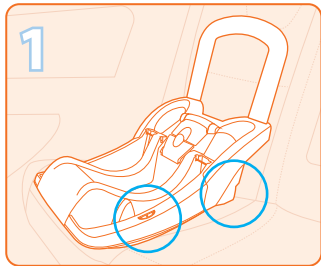

## BASE INSTALLATION

2. Locate the bubble indicator on either side of the base. The indicator must be within the check marks for proper recline angle.
3. If needed, use the Five-Position Leveling Foot to help adjust base to proper level.
  - Adjust the height of the leveling foot by pulling up on the tab located at the bottom of the foot.
  - The leveling foot can be adjusted to five different heights to achieve the desired angle.
  - Listen for audible **“click”** to confirm engagement.

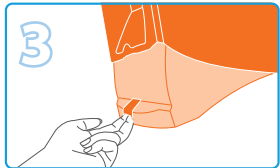
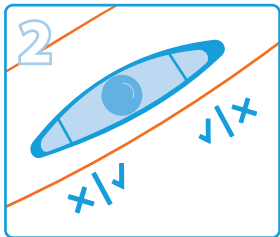

## BASE INSTALLATION

### INSTALLATION WITH LATCH/UAS

► *Make sure you check installation before every use!*

- 1. Place the base flat on the vehicle seat.**
  - Push the base firmly to the vehicle seat back.
  - Center the base between the LATCH/ UAS anchors.
  - Make sure the base is meeting the 80/20 guideline rules.

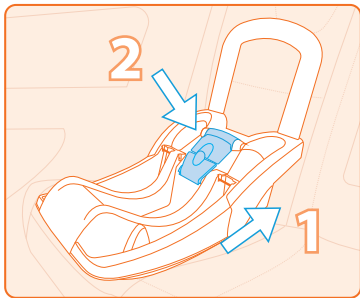

- 2. Locate and remove both of the LATCH/UAS connectors from storage compartment on top of the base.**

## BASE INSTALLATION

3. **Attach** each LATCH/UAS connector to the vehicle's LATCH/UAS anchors:
- Only **ONE** LATCH/UAS connector per LATCH/UAS vehicle anchor.
  - Make sure each LATCH/UAS connector strap is lying flat and not twisted.
  - Listen for audible **"click"** to confirm engagement.

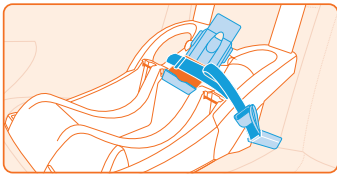
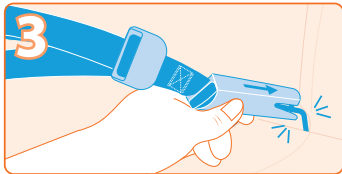

## BASE INSTALLATION

4. Tighten the LATCH/UAS strap by **pulling up** on the strap while **pressing** the base in the middle firmly into the vehicle seat.

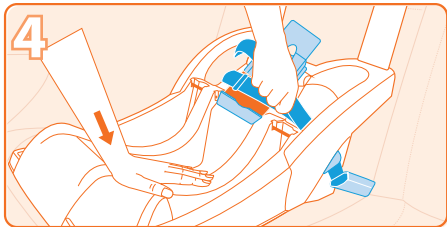

5. Lock the LATCH/UAS strap inside the belt lock-off by closing each panel and pushing down. Listen for audible **“click”** to confirm engagement. Make sure the adjustment strap does not interfere with the child restraint attachment to base and is not routed through the belt lock-off.

6. Test for tightness,

- Grab the base at the belt path only and try to move it side-to-side and front-to-back with the force of a firm handshake. If the base moves less than 1 in (2.5 cm), it is tight enough.
- ***If tested anywhere other than the belt path, there will be movement.***

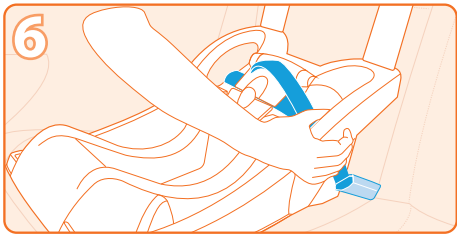



## BASE INSTALLATION

### INSTALLATION WITH VEHICLE SEAT BELT

- ▶ ***Make sure you check the installation before every use!***

1. Locate the EasyPath™ belt lock-off, open then thread the vehicle seat belt up and through the belt path on the side of the base.
  - Lay the vehicle seat belt flat over the open belt lock-off, making sure the vehicle belt is flat and not twisted.
  - Pull the vehicle seat belt down through the vehicle seat belt path on the opposite side of the base.
  - Buckle the vehicle seat belt.

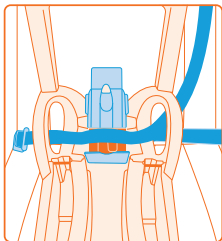
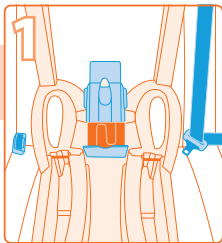

## BASE INSTALLATION

2. Tighten Belt,

A. **LAP/SHOULDER BELT**

Press down firmly in the center of the seat while pulling on the shoulder belt nearest to the buckle. Keep tension on the shoulder belt while feeding the slack back into the retractor.

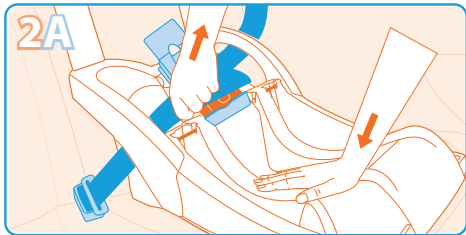

## BASE INSTALLATION

### B. LAP BELT

To tighten, press down firmly in the center of the car seat with one hand while tightening the lap belt strap with the other hand. You may need to tighten further by pulling in-line with the belt path. Make sure seat belt adjustment strap does not interfere with the child restraint attachment to base and is not routed through the belt lock-off.

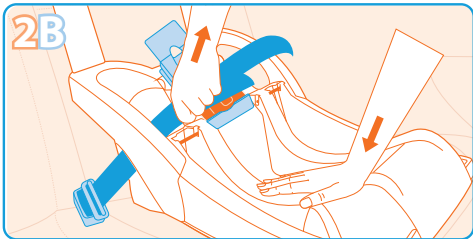

## BASE INSTALLATION

3. Lock the vehicle seat belt inside the belt lock-off by closing each panel and pushing down. Listen for audible **“click”** to confirm engagement.

When using the lap/shoulder belt,

- The vehicle seat belt is now locked and does not need to have its retractor locked.
- ***Ensure that both the lap and shoulder portion of the seat belt are closed in the lock-off.***

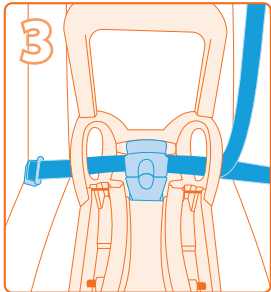

## BASE INSTALLATION

4. Test for tightness,
  - Hold the base at the belt path only and try to move it side-to-side and front-to-back with the force of a firm handshake. If the base moves less than 1 in (2.5 cm), it is tight enough.
  - ***If tested anywhere other than the belt path, there will be movement.***

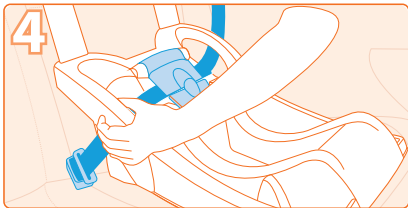

- ▶ ***Make sure to store the LATCH/UAS connectors properly in the compartment when not using them for installation.***

## BASE INSTALLATION

### SECURING CHILD RESTRAINT TO BASE

**Only use base with the LiteClik®30 R and RX SafePlus™ Infant Car Seats.**

1. First, make sure your base is securely attached to the vehicle.
2. Secure the child restraint rear-facing onto the base, by firmly pushing the child restraint onto the **attachment hooks** located on the base.
3. Lift up to confirm that the child restraint is securely installed on to the base.

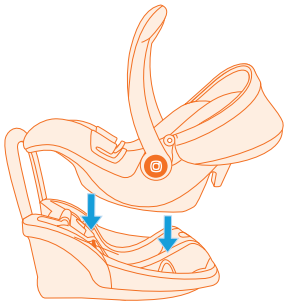

## BASE INSTALLATION

### REMOVAL OF **CHILD RESTRAINT** FROM BASE

Squeeze the child restraint release lever to disengage the hooks while pulling up on the handle to remove from the base.

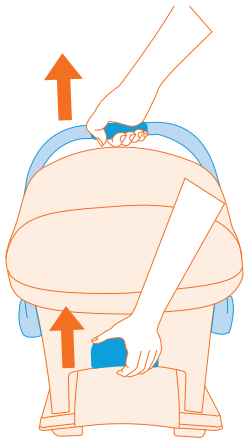

## SECURING CHILD

**This child restraint is designed for use only with children who weigh 4–30 lb (1.8–13.6 kg) and whose height is 30 in (81.3 cm) or less. The car seat can be used with a vehicle safety belt or the base.**

- ▶ Consult a doctor before use, especially with premature infants as they could have difficulty breathing in a seated position.
- ▶ Child must be seated against the back and bottom of the car seat and not slouched.
- ▶ **Never** place child in child restraint with bulky clothing or blankets that may interfere with the 5-point harness. Bulky clothing and blankets create more space between your child and the 5-point harness, giving you the sense that the harness is tightened correctly when it is actually too loose. The extra space compresses in a crash and can allow them to move beyond the protective shell of the car seat and even be ejected from their car seat.



## SECURING CHILD

The American Academy of Pediatrics (AAP), NHTSA, Transport Canada and Diono® **RECOMMEND** that children be rear-facing until they reach the maximum rear-facing height or weight of their car seat. This car seat is rear-facing only and can be used for children up to 30 lb (13.6 kg) or 30 in (76.2 cm) tall.

**Rear-facing is the safest position for your child. Even if your provincial, territorial, or state regulations allow you to move to a forward-facing seat, your child should keep using a rear-facing seat as long as possible.**

### BUCKLE STRAP ADJUSTMENT

- ▶ Make sure the child is **NOT** sitting directly on top of the buckle.
- ▶ There should not be a gap between the child and the buckle strap.
- ▶ Ensure the harness is not too high on the hips and adjust the buckle strap height as needed. ***Refer to the J-Routing Method to shorten buckle strap height.***

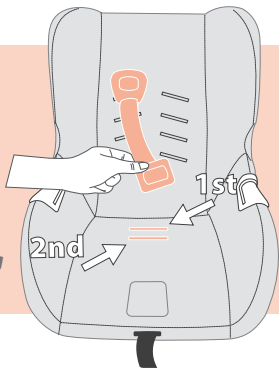

Either of the two buckle positions are acceptable, as long as the child is not sitting directly on top of the center buckle and that the buckle is at the correct height.

### J-ROUTING METHOD

If your buckle is too long to achieve the proper fit for your child, you can shorten your buckle strap by using the J-Routing method.

There are two different ways to shorten the buckle strap using the J-Routing Method:

- ▶ **Thread the metal retainer through the first buckle strap slot, and back up through the second slot or thread the metal retainer through the second buckle strap slot and back up through the first slot.**

Once routed, make sure the metal retainer is flush on top of the shell inside the cover.

## SECURING CHILD

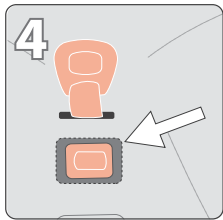
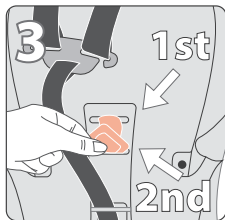
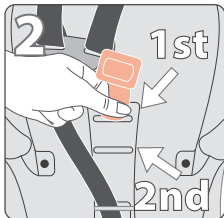
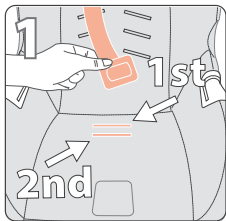

## SECURING CHILD

- ▶ **Before removal or installation, have your phone handy to take photos of the process for future reference.**

### HARNESS STRAP ADJUSTMENT

**This child restraint is equipped with two harness loops. Both harness loops can be used for children weighing 4 - 30 lbs (1.8 - 13.6 kg)**

- The first harness loop can be used to shorten the harness system for smaller children when a properly tightened harness cannot be achieved with the harness straps at or below the child's shoulders.

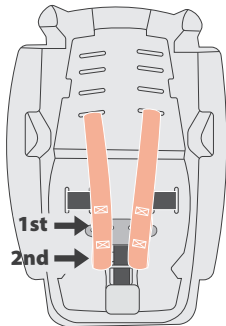

## SECURING CHILD

1. To loosen harness, push down on the harness strap release button and pull the shoulder straps forward.
2. Locate the metal plate on the back of the seat and remove the straps from the metal plate. Gently pull the straps out of the front of the child restraint.

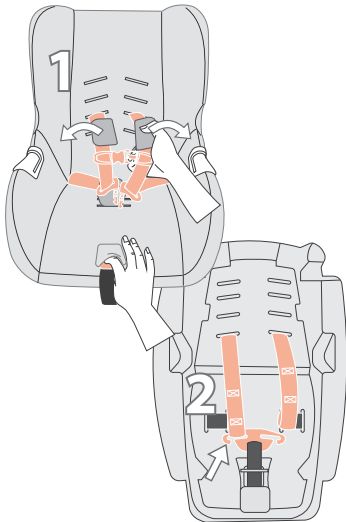

## SECURING CHILD

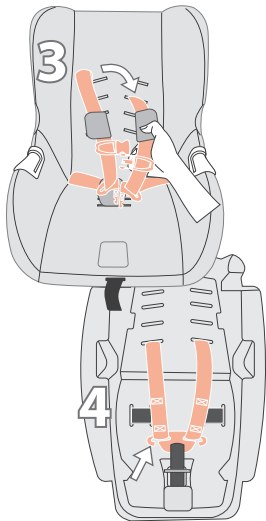

3. Relocate the harness straps to the appropriate harness slot that fits your child and push straps through to the back of the child restraint.
  - The harness needs to be snugly positioned at or below the child's shoulders. The top of head must be at least 1 in (2.5 cm) below the top of the car seat shell.
4. Secure the straps onto the metal plate located on the back of the child restraint.

### SITRITE™ COMFORT INSERT

Adjust the insert so that the child's head is fully surrounded by the headrest insert. The top of the head must be 1 in (2.5 cm) below the top of the car seat shell.

- **Secure the headrest insert by inserting the straps into the appropriate cover harness slots that fit your child, and then attach the hook and loop strips.**

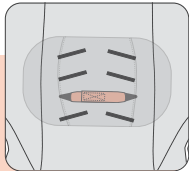
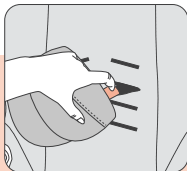

- ▶ ***Use of the SitRite™ Comfort Insert is optional and does not affect the safety of the seat.***



## SECURING CHILD

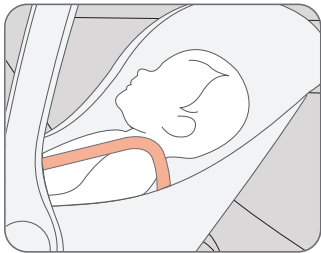

### SECURING CHILD

The harness needs to be snugly positioned at or below the child's shoulders. The top of head must be at least 1 in (2.5 cm) below the top of the car seat shell.

- ▶ Consult a doctor before use, especially with premature infants as they could have difficulty breathing in a seated position.
- ▶ **Never secure a child in this restraint on an elevated surface.**

## SECURING CHILD

1. Loosen harness.
  - Push down on the harness strap release button and pull the shoulder straps forward.
  - Unfasten the chest clip and the buckle and move the harness straps to the sides.
2. Properly position the child in child restraint so they are seated against the back and bottom of the seat and not slouched front-to-back or side-to-side.
  - Make sure the top of the child's head is at least 1 in (2.5 cm) below the top of the car seat shell.

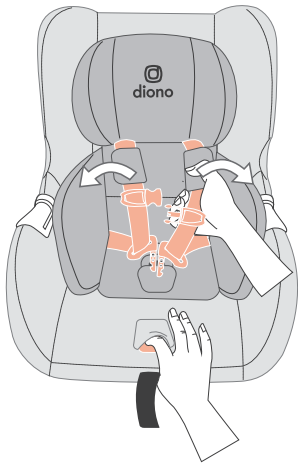

## SECURING CHILD

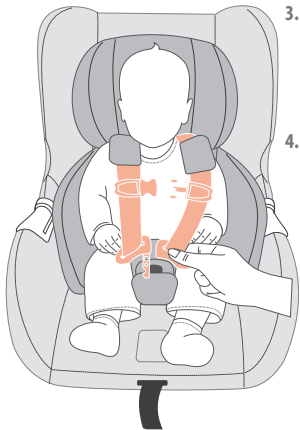

3. Position harness straps around the child.
  - Make sure the harness straps are at or just below the child's shoulders.
4. Buckle the harness.
  - Insert the buckle tongues into the buckle until an audible **"click"** is heard.
  - Gently pull the harness straps upwards to snugly fit the lap portion of the harness across the body and low on the child's hips.
  - Gently tug on the harness strap to make sure the buckle tongues are securely buckled.

## SECURING CHILD

5. Slowly pull the harness adjuster strap to tighten the harness for a comfortable and snug fit around the child.
  - Confirm that the harness is not twisted and lays flat against the child's shoulders, chest, and hips.
6. Properly position the chest clip level with the child's armpits then fasten the chest clip. Position the harness pads up to the child's shoulders.  
***Harness pads are optional and are not necessary for installation.***



## SECURING CHILD

7. Finally, do the **PINCH TEST**. Take the thumb and index finger and 'glide' your fingers along the harness at the collar bone. If you are able to pinch any of the webbing of the harness strap, tighten it again. If you can't pinch the harness, then it's properly tightened.

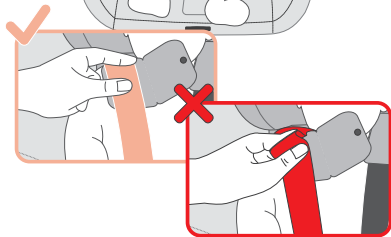

- If harness pads are used, you may need to unfasten the harness pad to access the strap to successfully administer the pinch test.

## INFANT CAR SEAT INSTALLATION WITHOUT THE BASE

**This child restraint is designed for use only with children who weigh 4–30 lb (1.8–13.6 kg) and whose height is 30 in (76.2 cm) or less.**

Consult a doctor before use, especially with premature infants as they could have difficulty breathing in a seated position.

- ▶ **Before installing your infant car seat, make sure your vehicle is on level ground.**
- ▶ **When installing with ONLY the infant car seat, you must place the handle in position four, the anti-rebound position.**

1. Place the child restraint on selected vehicle seat. Make sure it does not block the vehicle seat belt buckle.
2. Locate the level line indicator on the warning label on either side of the child restraint.

## INFANT CAR SEAT INSTALLATION WITHOUT THE BASE

3. Position the child restraint so that the level line indicator is **LEVEL** with the ground. The child restraint must fully be on vehicle seat. The bottom of the child restraint cannot overhang.

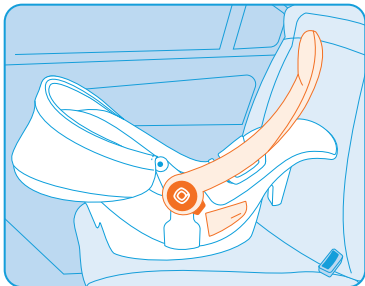

## INFANT CAR SEAT INSTALLATION WITHOUT THE BASE

- ▶ **Make sure the level line is level with ground.**
- ▶ **Never** install child restraint using a non-locking retractor without a belt locking clip. It will not be secure and may endanger the safety of your child in the case of a vehicle accident.
- ▶ Please refer to your vehicle owner's manual before child restraint installation without the base to make sure your car is compatible with the installation requirements.
- ▶ **When installing with ONLY the infant car seat, you must place the handle in position four, the anti-rebound position.**



## INFANT CAR SEAT INSTALLATION WITHOUT THE BASE

1. Thread the **lap portion** of the vehicle seat belt up and through both belt guides on the sides of the child restraint.
  - Make sure the vehicle seat belt is flat and not twisted.
  - Buckle the vehicle seat belt.

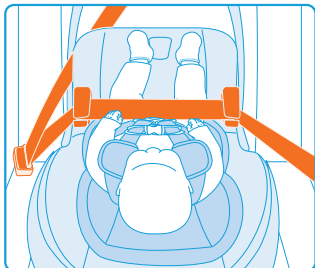
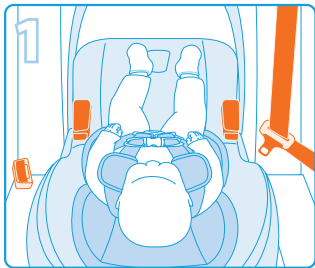

## INFANT CAR SEAT INSTALLATION WITHOUT THE BASE

2. Tighten Belt.

A. **LAP/SHOULDER BELT**

**Lock your vehicle seat belt retractor.** Once the retractor is locked, press down firmly with your forearm placed on top of the car seat while pulling on the shoulder belt nearest to the buckle. Keep tension on the shoulder belt while feeding the slack back into the retractor

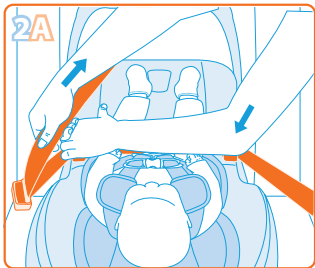

## INFANT CAR SEAT INSTALLATION WITHOUT THE BASE

### B. LAP BELT

To tighten, press down firmly with your forearm placed on top of the car seat while tightening the lap belt strap with the other hand. You may need to tighten further by pulling in-line with the belt path.

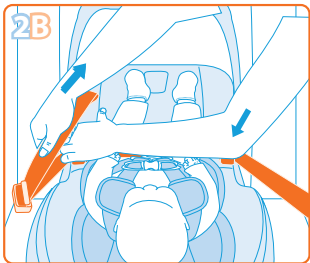

## INFANT CAR SEAT INSTALLATION WITHOUT THE BASE

3. Test for tightness,
- Hold the car seat at the belt path only and try to move it side-to-side and front-to-back with the force of a firm handshake. If it moves less than 1 in (2.5 cm), it is tight enough.
  - ***If tested anywhere other than the belt path, there will be movement.***

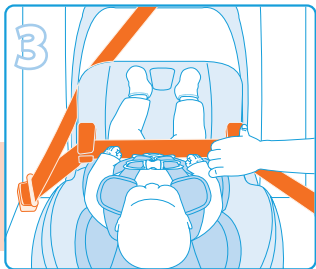

- ▶ ***Make sure you check child restraint installation before every use!***

## AIRCRAFT INSTALLATION WITHOUT THE BASE

This child restraint is designed for use only with children who weigh 4–30 lb (1.8–13.6 kg) and whose height is 30 in (76.2 cm) or less. **This child restraint is certified for use in aircraft only when installed without the base.**

Diono® and the US Federal Aviation Administration (FAA) strongly urge you to secure your child in a child restraint system (CRS) or device for the duration of your flight. Please contact the airline for their specific policies.

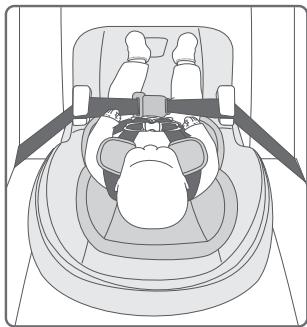

**For aircraft installation, please see INSTALLATION WITH VEHICLE SEAT BELT LAP ONLY. DO NOT USE BASE ON AIRCRAFT.** Aircraft seat belt buckle will interfere with installation of base.

### LITECLIK®30 RX SAFEPLUS™ ADAPTER (Only included with select models)

The LiteClik®30 RX SafePlus™ adapter is compatible with most Maxi-Cosi®, Britax® and Chicco® strollers.

- ▶ **Review your stroller manual for compatibility.**

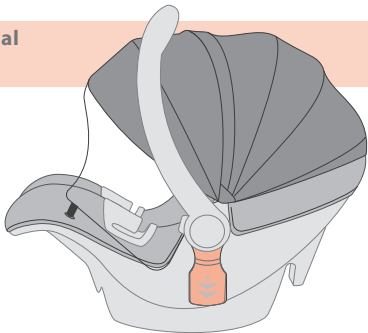

- ▶ **Before removal or installation, have your phone handy to take photos of the process for future reference.**

### BUCKLE STRAP REMOVAL

1. Remove buckle pad.
2. Locate the buckle's metal retainer from the back of the seat and push it up and out of the buckle's belt slot.
  - ▶ Rotate the metal retainer vertically while pushing it up and out of the center of the buckle's belt slot while simultaneously pulling up on the buckle.

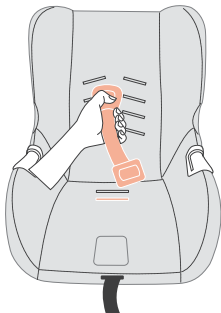
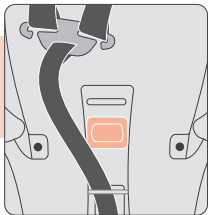

### BUCKLE STRAP INSTALLATION

1. Make sure the red release button faces towards the front of the car seat and the buckle strap is not twisted.
2. Slide the buckle's metal retainer down through the correct buckle belt slot that best fits your child taking care to keep the strap flat and not twisted.
3. Secure the buckle's metal retainer into the slot located on the back of the seat.

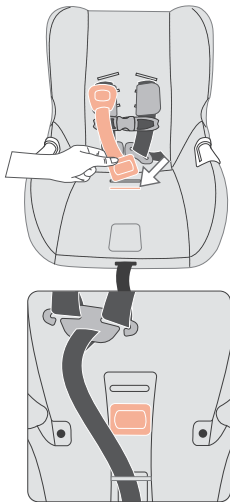



## CARE & MAINTENANCE

4. Attach the buckle pad to the buckle.
5. Pull up on the buckle strap to confirm the buckle is secured.

- ▶ ***If the buckle strap is too long to achieve the proper fit for your child, you can shorten the buckle strap by using the J-Routing method.***

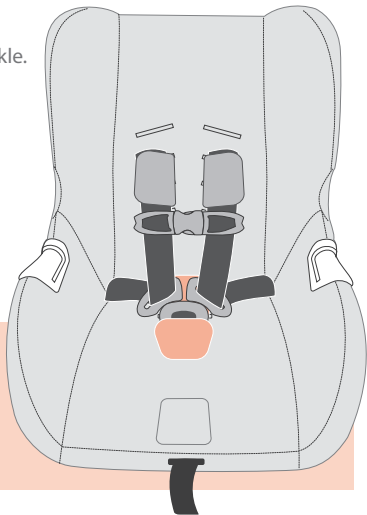

### HARNESS STRAP REMOVAL

1. Locate the metal plate on the back of the seat and remove the straps from the metal plate. Gently pull the straps out of the front of the child restraint.
2. Remove harness pads, chest clip, and buckle tongues.
3. Pull the strap through the back side of the seat and out through the front.

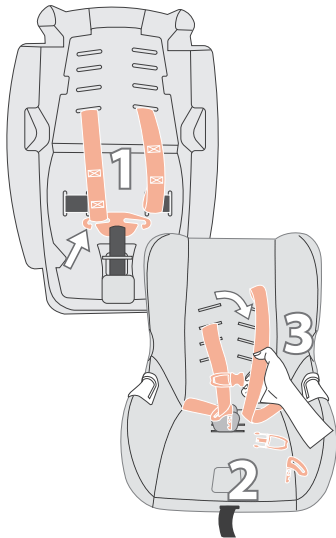

### HARNESS STRAP INSTALLATION

1. Attach one side of the harness strap to the metal plate that is located on the back of the seat.
2. Feed the strap all the way through the correct harness slot on the top of the seat.
3. Attach to one side of the chest clip then to one buckle tongue making sure the strap is flat and not twisted.

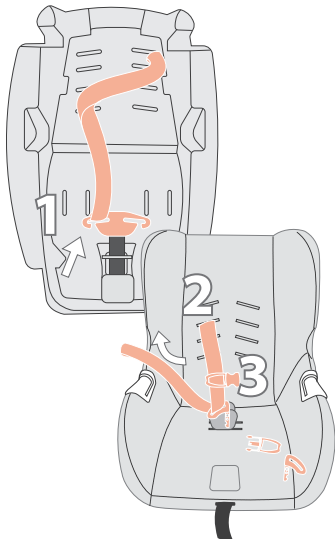

## CARE & MAINTENANCE

4. Feed the strap into the harness slot located on the side of seat and out the harness slot located on bottom of the seat. Loop harness through to the adjacent harness slot.
5. Reach under the cover and feed the strap into the other harness slot. Loop harness through to the adjacent harness slot.
6. Feed the harness strap out the front of the side harness slot.

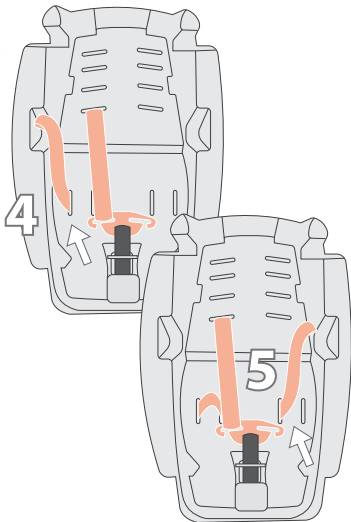

## CARE & MAINTENANCE

7. Attach the other buckle tongue and then feed through the other side of the chest clip.
8. Feed the strap through the correct upper harness slot.
9. Attach the strap to the metal plate located on the back of the seat.

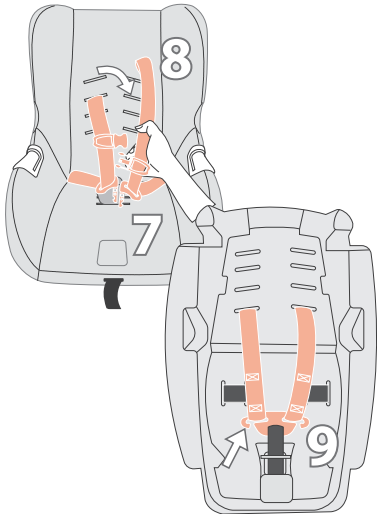

### COVER **REMOVAL**

1. Remove the SitRite™ Comfort Insert, buckle pad and harness system.
2. Remove the plastic tabs from the sides of the child restraint.
3. Push the canopy forward towards the carry handle.
4. Remove the cover from the outer edge of the child restraint shell and work your way inwards.

### COVER INSTALLATION

**Make sure the cover is securely attached in place before securing your child.**

1. Fit the cover around the shell of the child restraint.
2. Insert plastic tabs into the side of the child restraint shell.
3. Assemble harness system and attach buckle pad.

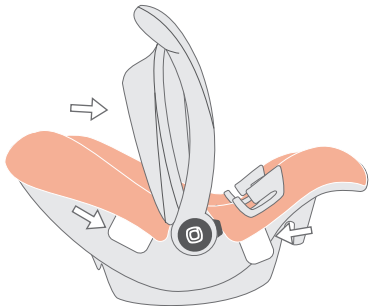

### CANOPY SHADE (Only included with select models)

1. Locate the zipper on canopy. Unzip the pouch and pull out the canopy shade.
2. Feed the J-shaped hook through the buttonhole on the seat cover and hook it onto the seat shell.
3. Then, attach the elastic loop on the canopy to the corner of the seat shell.

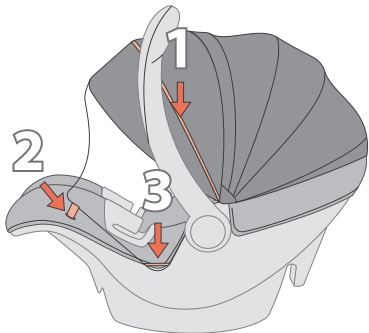



## CARE & MAINTENANCE

- ▶ **Remove the manual from the child restraint cover before washing.**

**CLEANING FABRICS:** Seat cover, infant support pads, center buckle pad and harness pads. Machine wash separately in cold water on gentle cycle with mild detergent or hand wash fabrics in cold water. Dry flat and away from direct sunlight before re-use or storage. **DO NOT bleach, iron or dry clean.**



**CLEANING HARNESS AND BUCKLE STRAPS:** Clean with damp cloth only. Wet cloth with warm water and mild soap. Wring cloth thoroughly and spot clean. Allow it to dry completely before use. **DO NOT use solvents, bleach, or abrasive cleaners. DO NOT soak or submerge the harness webbing.**



## CARE & MAINTENANCE

**CLEANING PLASTICS:** Spot clean using a damp cloth and warm water with mild detergent. Towel dry completely before re-use or storage. **DO NOT bleach.**



**CLEANING CENTER BUCKLE:** Remove the center buckle from the car seat. Gently rinse **ONLY** the buckle mechanism in warm water or soak overnight. **DO NOT** soak or submerge the buckle strap. Towel dry buckle and let air dry. Make sure the buckle is working correctly before reconnecting the center strap to car seat. **DO NOT use detergents or lubricants.**

# WARRANTY

As a part of this Diono® Warranty Policy (Policy), Diono®, L.L.C. dba Diono®, a Washington limited liability company (Diono® U.S.A.), and its foreign-related companies, Diono® ULC, a Canadian unlimited liability company (Diono® Canada), Diono® Ltd. a United Kingdom limited company (Diono® U.K.), and Diono® GmbH, a German company with limited liability (Diono® E.U.) (Diono® U.S.A., Diono® Canada, Diono® U.K., and Diono® E.U. shall be collectively referred to herein as Diono®), warrants its products, namely its car seats, strollers, baby carriers, and accessories thereto (collectively, the Products) to their non-merchant original retail Product purchasers (collectively, the Purchasers) as follows:

## 1. REGISTRATION

To qualify for the warranties detailed in this Policy, Diono® instructs all Purchasers to complete the online Product Registration form and mail the owner registration card included in the Product Purchase to Diono® within (30) days of purchase. Failing to take such actions may prevent a Purchaser from qualify for the warranties detailed in this Policy. For more information about Product registration, Purchasers are recommended to refer to their Product's Product Manual, the Diono® Instruction Manual, and/or contact Diono® as provided in Section 9 of this Policy. Such registration requirements detailed in this subsection of the Policy do not apply to warranties provided by Diono® E.U. as detailed in Section 2.4 below.

## 2. GENERAL WARRANTY PERIOD

**2.1 General U.S. Warranty Period.** Diono® U.S.A. warrants to Purchasers that its Products will be free from defects in material and workmanship for one (1) year from the date of original purchase (the U.S. Warranty Period). During the U.S. Warranty Period, Diono® U.S.A. will, at its option, repair or replace a Product if it is found by Diono® U.S.A. to be defective in material or workmanship.

**2.2 General Canadian Warranty Period.** Diono® Canada warrants to Purchasers that its Products will be free from defects in material and workmanship for one (1) year from the date of original purchase (the Canadian Warranty Period). During the Canadian Warranty Period, Diono® Canada will, at its option, repair or replace a Product if it is found by Diono® Canada to be defective in material or workmanship.

## WARRANTY

**2.3 General U.K. Warranty Period.** Diono® U.K. warrants to Purchasers that its Products will be free from defects in material and workmanship for one (1) year from the date of original purchase (the U.K. Warranty Period). During the U.K. Warranty Period, Diono® U.K. will, at its option, repair or replace a Product if it is found by Diono® U.K. to be defective in material or workmanship.

**2.4 General European Warranty Period.** Diono® E.U. warrants to Purchaser that its Products are in conformity with their original contracts of sale (collectively, the Contracts), and notably will be free from defects in material and workmanship at the time the Products were delivered to Purchaser, for two (2) years from the date of original purchase (the European Warranty Period). The Products are presumed to be in conformity with the Contract if they are fit for the purposes for which products of the same type are normally used, or show the quality and performance which are normal in products of the same type and which Purchaser can reasonably expect, given the nature of the Products and taking into account any public statements on the specific characteristics of the goods made about them by Diono®, particularly in advertising or on labelling. Purchaser must inform Diono® E.U. of the Lack of Conformity within a period of two (2) months from the date on which Purchaser detected such lack of conformity discovery. There shall be deemed to not be a Lack of Conformity at the time the Contract was concluded when Purchaser was aware, or could not reasonably be unaware, of the Lack of Conformity. During the European Warranty Period, Diono® E.U. will, at the Purchaser's option, repair or replace a Product free of charge, within a reasonable time and without any significant inconvenience to the Purchaser, if it is found by Diono® E.U. to be defective in material or workmanship respectively, unless this is impossible or disproportionately burdensome. When repair or replacement of a Product are impossible or disproportionately burdensome, the Purchaser may request a refund of the Product or a reduction of its price in proportion to the degree of non-conformity of the said Product, otherwise in accordance with the Diono® Return Policy.

### 3. IMPLIED WARRANTIES

Any implied warranties applied to a Product, including without limitation implied warranties of merchantability and fitness for a particular purpose, shall be limited to the duration and terms of the express written warranties detailed in this Policy. Such warranties give Purchasers specific legal rights, which vary from jurisdiction-to-jurisdiction. Some U.S. states and Canadian provinces do not allow limitations on how long an implied warranty lasts or the exclusion or limitation of incidental or

## WARRANTY

consequential damages. As such, such implied warranty limitations may not apply. Notwithstanding, neither Diono®, nor any retailer selling any Product, authorizes any person to create for it any other warranty, obligation, or liability in connection with any Product not otherwise detailed in this Policy.

### 4. WARRANTY LIMITATIONS

**4.1 Damage Limitations.** The warranties identified in this Policy do not cover: (a) any Product purchased from a non-authorized Diono® retailer; (b) the effects of normal wear and tear on a Product; (c) damage arising from Product repairs or modifications carried out by a third party; (d) a Product's involvement in an accident; (e) dissatisfaction with a Product's fit, weight, functionality, color or style; (f) Product damage resulting from negligence, modification, improper installation, accident, transport damage, incorrect washing of covers, corrosion, rust, mold, insufficient maintenance, misuse or abuse ; or (g) any Product defect that originated from material or design supplied by the Purchaser.

**4.2 Remedy Limitations.** It is expressly agreed that Diono®'s obligations and a Purchaser's remedies under the limited warranties provided in this Policy are exclusive and are strictly limited to the repair or replacement of a Product unless as otherwise detailed in Section 2 of this Policy. Such limited warranties are also conditional upon strict compliance with the provisions of the Instruction Manual for the Product(s) in question. In no event will Diono® or any of their authorized manufacturers or retailers be liable to a Purchaser for any damages, including without limitation incidental or consequential damages, arising out of a Purchaser's use or inability to use any Product.

**4.3 Other Requirements and Limitations.** The warranties detailed in this Policy: (a) are non-transferable by Purchaser; (b) are only valid when supplied with proof of purchase from an authorized retailer or the Website; and (c) are valid only in the original country of the Product's purchase.

## WARRANTY

### 5. USE OF OUTSIDE PARTS AND ACCESSORIES

The use of covers, inserts, toys, accessories, or tightening devices produced by parties other than Diono® or its authorized manufacturers (collectively, Outside Products) in any Product is not approved by Diono®. The use of any Outside Product in conjunction with a Product could cause the Product to fail U.S., Canadian, U.K., and/or European safety standards. As a result, use of any Outside Product with a Product automatically voids any warranties granted under this Policy.

### 6. RESERVED RIGHTS

Diono® reserves the right to: (a) discontinue any Product; (b) change a Product's parts, fabrics, or design; (c) substitute a Product with a comparable model or Product; or (d) apply a divergent manufacturer's guarantee for a Product in any specific geographical region.

### 7. SHIPPING CHARGES

Shipping charges for the replacement of any Product pursuant to a warranty granted under this Policy will be Purchaser's sole responsibility. Diono® will not be responsible for any delays or damage caused by the shipment of a replacement Product. More information about Diono®'s shipping policies can be found in the Diono® Shipping Policy.

### 8. QUESTIONS

Should any Purchaser have issues concerning a warranty or this Policy, Diono® recommends contacting Diono® Customer Service at 855-463-4666 or [support@Diono®.zendesk.com](mailto:support@Diono®.zendesk.com) for help or assistance for the U.S.. For Canada, call 1-866-954-9786 or [support@Diono®.zendesk.ca](mailto:support@Diono®.zendesk.ca) for help or assistance.



# diono®

#MadeOfSeattle



© 2024 Diono® LLC | 14810 Puyallup Street E | Suite 200

Sumner WA 98390 | United States

United States: [Diono.com](http://Diono.com) | 1-855-463-4666

Canada: [Diono.ca](http://Diono.ca) | 1-866-954-9786

Made in China | Fabriqué en Chine | Fabricado en China

All rights reserved | Tous droits réservés | Reservados todos los derechos

revised/modifié/revisado 20240826